

CLASS 125 / PN16 / JIS 10K

Flanged Orifice Air Valve

Fig. 9101



Pressure Temperature Ratings

Working pressure	16bar
Testing Pressure	Shell:24bar
	Seal:17.6bar
Working Temperature	-10°C to 100°C

Material Specification

Part	Material	EN Spec.
Body	Ductile Iron	EN-JS1050
Orifice Cover	Ductile Iron	EN-JS1050
Air Release Nipple	Brass	EN 12165 CW603N
Screw Plug	Brass	EN 12165 CW603N
Float Ball	ABS (ISO2580)	Commercial
Ball Seal Orifice	EPDM	Commercial

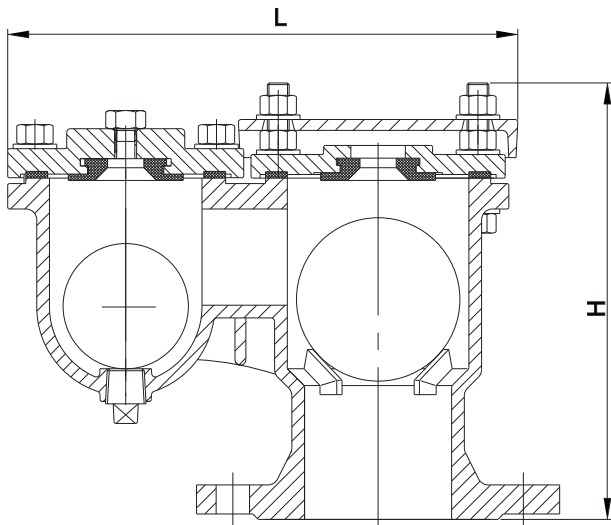

Note:

DN25 is only available by screw thread.

Dimensions

DN	mm	25	40	50	65	80	100	125	150	200	250
	inch	1	1-1/2	2	2-1/2	3	4	5	6	8	10
L		147	224	273	273	283	302	353	353	433	491
H		185	187	214	214	244	270	323	323	401	450