

CLASS 125 / CLASS 250

Variable Orifice Double Regulating Valve

Fig. 1210-DF

ANSI Flanged Ends for Single Unit Systems Conforms to BS7350



Specification

These are Y-pattern globe valves fitted with two pressure test valves to provide flow measurement, regulation and isolation. Valves conform to requirements of BS7350.

Application

Primarily used in injection or other circuits requiring a double regulating valve for systems balancing. Accuracy of flow measurement is $\pm 5\%$ at all open positions of the valve. Some reduction in accordance with BS 7350.

Pressure/Temperature Ratings

| | PN16 | PN25 |
|-----------------------|------------|------------|
| Temperature °C | -10 to 120 | |
| Working Pressure(Bar) | 16 | 25 |
| Test Pressure(Bar) | Shell:24 | Shell:37.5 |
| | Seat:17.6 | Seat:27.5 |

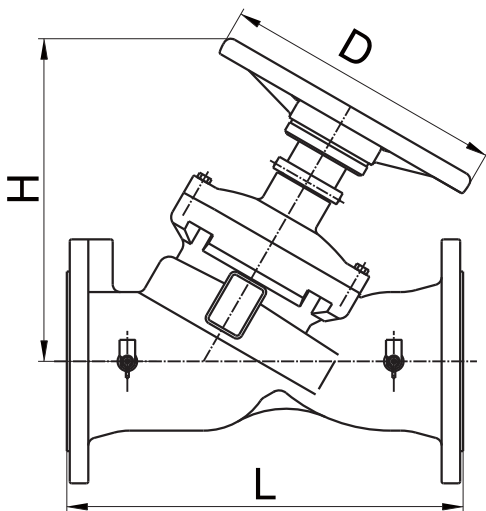

Materials

| Part | Material | ASTM Specification |
|---------------------|---------------------|--------------------|
| Body | Ductile | A536 65-45-12 |
| Bonnet | Ductile | A536 65-45-12 |
| Stem (65-300mm) | Stainless Steel 410 | AISI 410 |
| Stem (350-600mm) | Stainless Steel 431 | AISI 431 |
| Disc | EPDM Coated DI | A536 65-45-12 |
| Gland (65-150mm) | Brass | B124 C37700 |
| Gland (200-600mm) | Ductile | A536 65-45-12 |
| Stem Nut | Brass | B124 C37700 |
| Hand Wheel | Ductile | A536 65-45-12 |
| Test Valve | Brass | B453 C35330 |
| Packing | Graphite | Non-Asbestos |

Dimensions, Coefficients

| Size | Inch mm | 2½ DN65 | 3 DN80 | 4 DN100 | 5 DN125 | 6 DN150 | 8 DN200 | 10 DN250 | 12 DN300 | 14 DN350 | 16 DN400 | 18 DN450 | 20 DN500 | 24 DN600 |
|---------|------------|------------|-----------|------------|------------|------------|------------|-------------|-------------|-------------|-------------|-------------|-------------|-------------|
| L | | 290 | 310 | 350 | 400 | 480 | 600 | 730 | 850 | 980 | 1100 | 1200 | 1250 | 1450 |
| H | | 265 | 270 | 310 | 340 | 340 | 537 | 570 | 690 | 685 | 965 | 1020 | 1065 | 1180 |
| D | | 200 | 200 | 240 | 290 | 290 | 350 | 420 | 420 | 420 | 640 | 640 | 640 | 640 |
| Flow Kv | | 83.8 | 119.5 | 178.7 | 272.7 | 380.0 | 608.0 | 1292.0 | 1791.5 | 2261.0 | 3769.0 | 4221.0 | 4728.0 | 5674.0 |
| Head K | | 3.78 | 5.24 | 9.53 | 6.98 | 5.35 | 6.26 | 5.57 | 6.43 | 11.40 | 12.40 | 13.10 | 13.50 | 13.90 |