

Pressure Test Valves

Fig.1200-PT

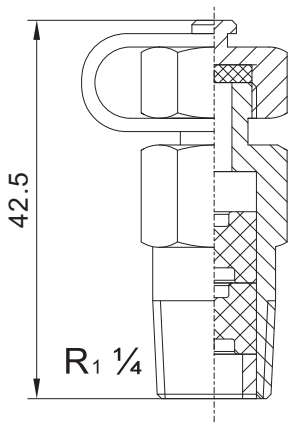

Pressure Test Valves

Specification

Taper threaded to BS EN 10226-2 (ISO 7-1) formerly BS21
 1200 insrtion style pressure test points are fitted as standard to Flow Measurement Device and regulation valves.

Dimensions/Coefficients:

Temperature °C	-10 to 100	110	120
Pressure(Bar)	25	25	25

Materials:

Part	Material	Specification
Cap	Brass	BSEN12165 CW602N
Cap Washer	EPDM	
Body	Brass	BSEN12165 CW602N
Tie	Polypropylene	
Seal	EPDM	
Retaining Ring	Brass	BSEN12165 CW602N

Fig. 1200-ET

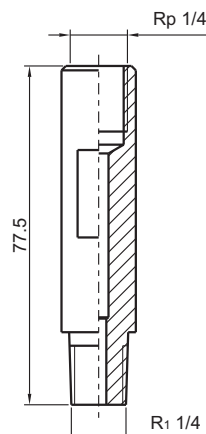

Extension Tube

Specification

Taper threaded to BS EN 10226-2 (ISO 7-1) formerly BS21

Dimensions/Coefficients:

Temperature °C	-10 to 100	110	120
Pressure(Bar)	25	25	25

Materials:

Part	Material
Extension Tube	Stainless steel